

HANFORD MALL

1675 W. Lacey Blvd, Hanford, CA 93230

MAIN LEVEL

LEASE PLAN



- General Notes:
- This exhibit is diagrammatic. It is intended only for the purpose of indicating the location of the demised premises within the project. It does not purport to show the exact or final location of columns, walls, stairways or other Architectural, Structural, Mechanical or Electrical elements. The landlord reserves the right to eliminate, to add to and to make changes to the sizes and/or locations of such elements as may be required from time to time.
 - Dimensions and areas, where indicated for individual premises, are measured under the following:
 - Centerline to Centerline of demising walls.
 - Exterior face of all exterior walls.
 - To the exterior face of and corridor or building wall.
 - The tenant, the Tenant's Architect & the Tenant's Contractor have complete and total responsibility to verify all conditions and dimensions, and all utility connection points, in the field before starting and design, documentation & construction work.

REVISION DATE

5/11/10

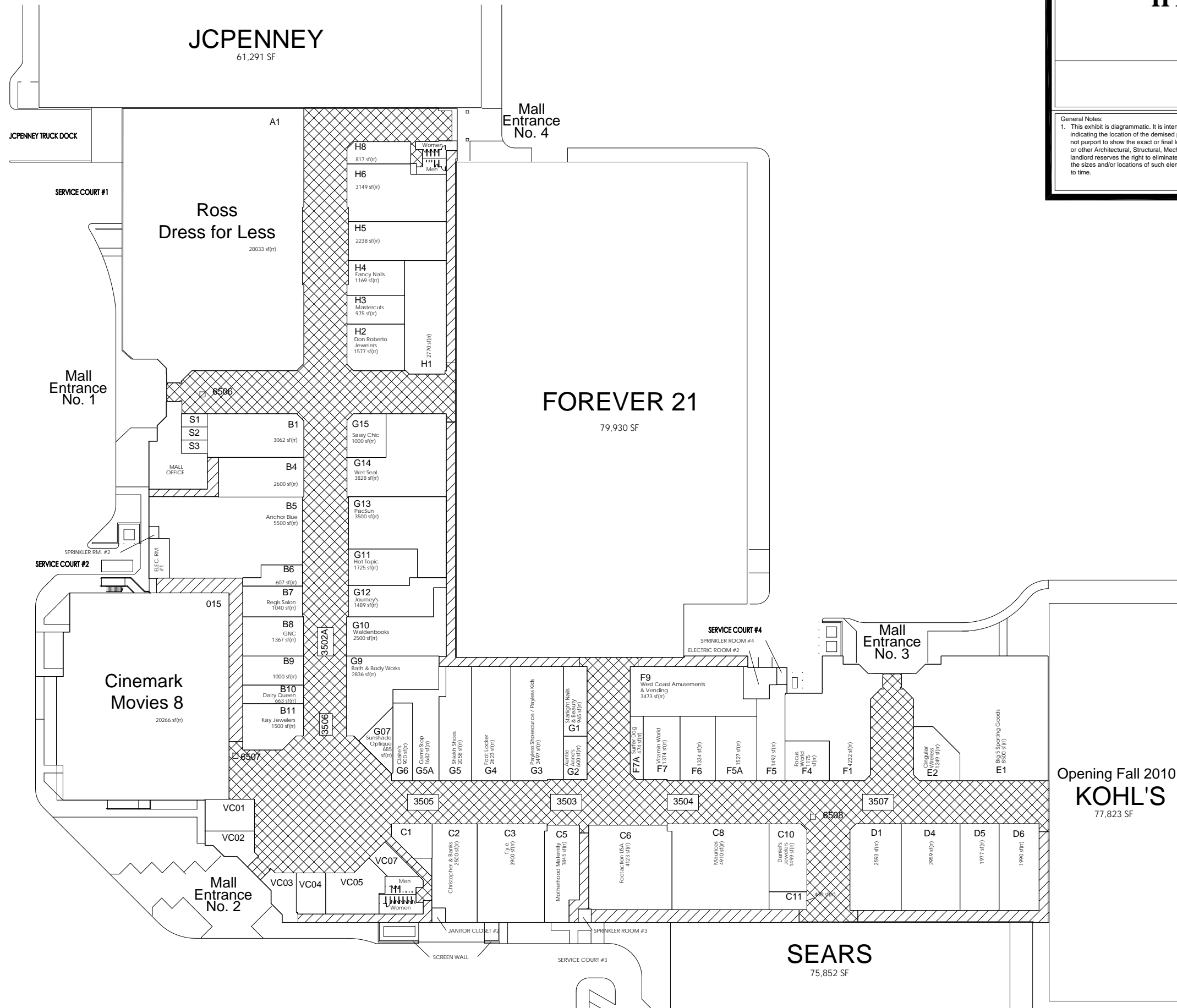

FOOD COURT TENANTS	
C1	680 sf (nr)
VC01	Charley's Grilled Subs 937 sf (nr)
VC02	Romanos Pizza 723 sf (nr)
VC03	Subway 732 sf (nr)
VC04	Serrano's Mexican Grill 708 sf (nr)
VC05	Chinese Gourmet/Original Teriyaki 1498 sf (nr)
VC07	A&W All American Food 491 sf (nr)
STORAGE ROOMS	
S1	sf (nr)
S2	sf (nr)
S3	sf (nr)

KIOSK TENANTS	
3502A	1-Mobile 120 sf (nr)
3503	Photo and Engraving 288 sf (nr)
3504	Intrigue Jewelers 180 sf (nr)
3505	Lids 170 sf (nr)
3506	150 sf (nr)
3507	Cricket 150 sf (nr)
6506	ASAJ ATM 16 sf (nr)
6507	ASAJ ATM 16 sf (nr)
6508	ASAJ ATM 16 sf (nr)

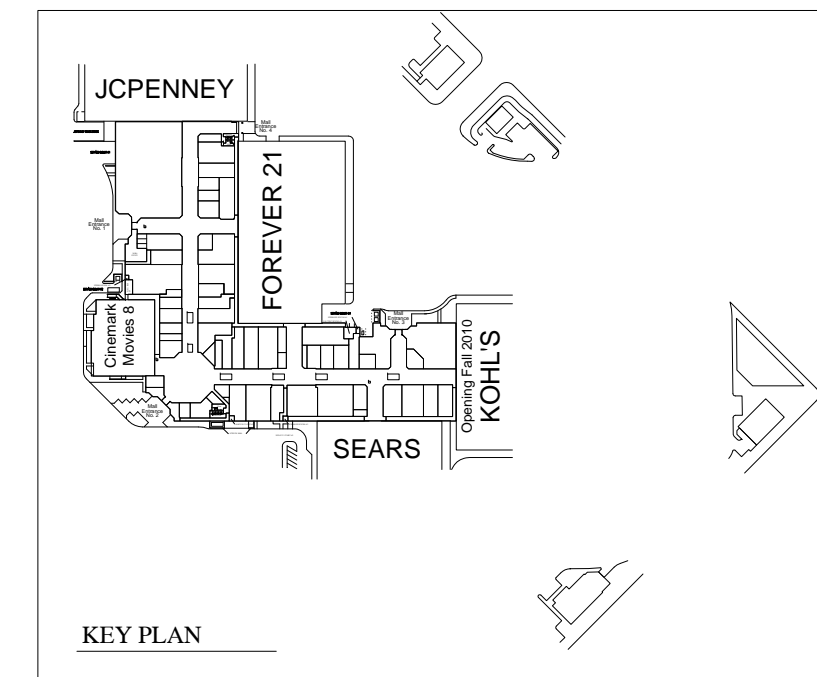

KEY PLAN